

UNISTORM VAULT SIZING TABLE							
UNISTORM MODEL #	WIDTH (ft.)	LENGTH (ft.)	MAX. S (ft.)	IMPERVIOUS AREA (acres)	INLET PIPE (in.)	TREATMENT FLOW (cfs)	PEAK FLOW (cfs)
48V	4	8	5.0±	0 - 2	12	0 - 1	4
510V	5	10	5.3±	2 - 4	15-18	1 - 2	6
612V	6	12	5.6±	3 - 4	18-24	2 - 6	10
1020V	10	20	6.0±	4 - 12	24-30	6 - 10	25

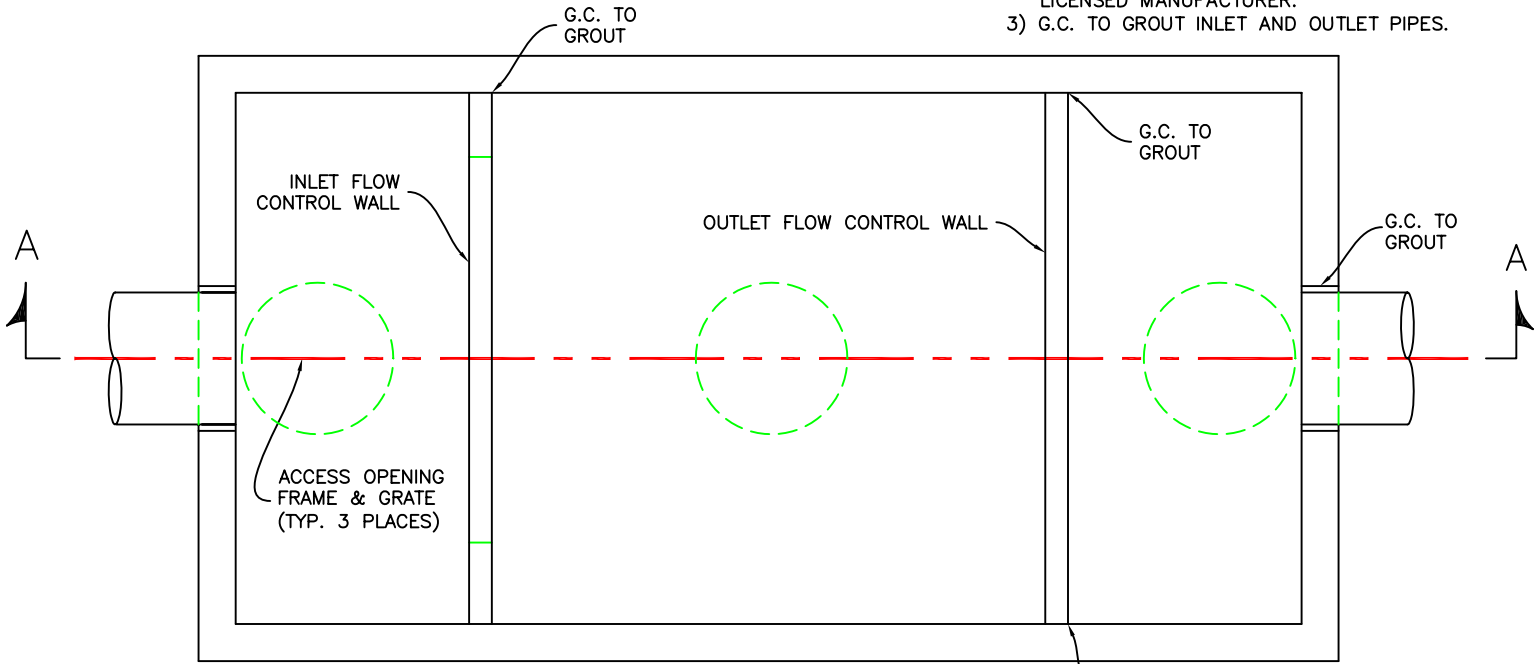

**CALL: 1-800-809-2801**

- NOTES:
- 1) RAINFALL INTENSITY USED FOR TREATMENT FLOW = 0.80-1.0 IN/HR
  - 2) MAXIMUM OPERATING LOSS APPROXIMATELY 0.5 FT
- MANUFACTURING NOTES:
- 1) DESIGN OF INTERNAL Baffle WALLS PROVIDED TO LICENSED MANUFACTURER BY ENVIRONMENT 21, LLC.
  - 2) LOCATION AND SIZE OF MANHOLE OPENINGS MAY BE ADJUSTED BY LICENSED MANUFACTURER.
  - 3) G.C. TO GROUT INLET AND OUTLET PIPES.



SITE-SPECIFIC SIZE, SHAPE, AND LOCATION OF FLOW CONTROL OPENINGS BY ENVIRONMENT 21, LLC

PLAN

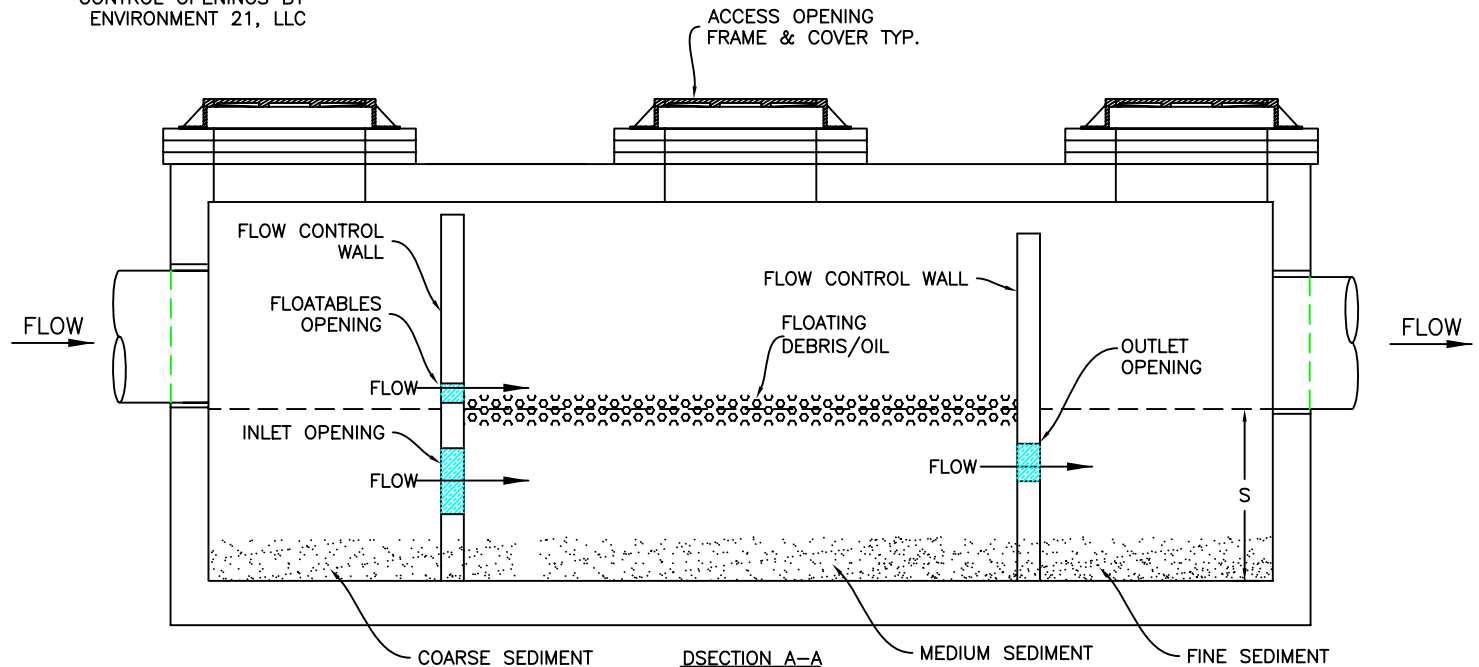

DSECTION A-A

Q:\ENR21\Stormwater-Treatment\marketing\ENR21\_Web\stie\stie\Stormwater\Specifying Documents\Unistorm-V-detail.dwg